



By: Richard Quatier

Stop Fake Email Addresses

From mucking up your CRM

Stop Fake Emails in online forms From loading into your CRM

A screenshot of a registration form titled 'REGISTER'. It features a purple header with a user icon. Below the header are four input fields: 'Username', a password field (masked with dots), another password field (masked with dots), and an email field containing 'FakeEmail.com'. There is a checkbox for 'I agree to the Terms of Service' and a purple 'REGISTER' button. A red error message 'Please enter a valid email' is displayed below the email field. At the bottom, there is a link 'Already a member? Login Here'.

1. If user enters a fake email address
2. Email Validation fails
3. User gets a request for a valid email
The user can be messaged by tool tip or other methods.
4. The form cannot be submitted

A screenshot of a registration form titled 'REGISTER'. It features a purple header with a user icon. Below the header are four input fields: 'Username', a password field (masked with dots), another password field (masked with dots), and an email field containing 'TrueEmail.com'. There is a checkbox for 'I agree to the Terms of Service' and a purple 'SIGN UP' button. At the bottom, there is a link 'Already a member? Login Here'.

1. If user enters a true email address
2. Email validation succeeds
3. Form submission is permitted
4. The form process continues normally
5. Your CRM receives only valid email addresses

Note: Requires subscription to an email service validator

Stops FAKE Emails from loading into all Backend Applications.

EXAMPLES: HUBSPOT – SALESFORCE – CONSTANT CONTACT – ACTIVE CAMPAIGN – PIPEDRIVE – ZENDESK – FRESHSALES – ORACLE NETSUITE – OMNISEND – SENDINBLUE – INFUSIONSOFT – ACT – MAUTIC -

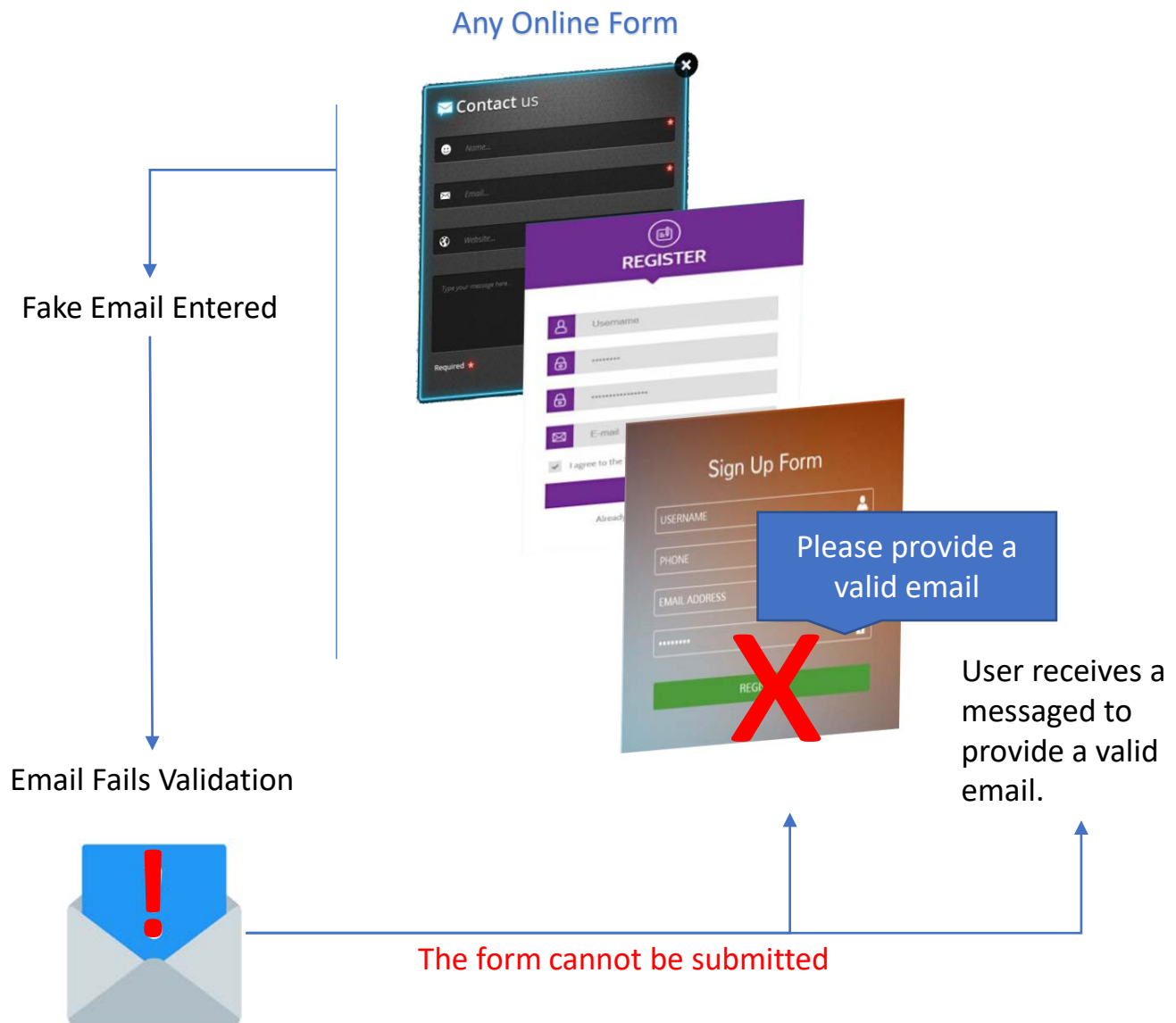

Only a functioning email allows forms to be submitted and loaded into your backend application.

All personal and business email address can be validated. Personal domains can be blocked if required.
(examples: @google.com, @yahoo.com, etc.)